

e- READING MANUAL

ASS-114

Human Values and Ethics

Credit hrs: 1(1+0)

B.Sc. (Hons.) Agriculture

Prepared by

Pankaj Kumar Ojha

Dheeraj Mishra

B.K. Gupta

Arjun Prasad Verma

B.P. Mishra

Director Research
B.U.A.T., Banda-210001 (U.P.)

(S.K. Singh)
Registrar
Banda University of Agriculture & Technology
Banda-210001 (U.P.)

Department of Agricultural Extension

College of Agriculture

Banda University of Agriculture and Technology

e-Reading Manual on Human Values and Ethics

Year

January, 2022

Copyright

Banda University of Agriculture and Technology, Banda

Publication No.: BUAT/(M)/2022-12

Prepared by:

Pankaj Kumar Ojha

Dheeraj Mishra

B.K. Gupta

Arjun Prasad Verma

B.P. Mishra

Director Research
B.U.A.T., Banda-210001 (U.P.)

(S.K. Singh)
Registrar
Banda University of Agriculture & Technology
Banda-210001 (U.P.)

Published by:

College of Agriculture

Banda University of Agriculture and Technology

Banda-210001 (Uttar Pradesh)

Abstract

The "Human Values and Ethics" e-reading manual specifically caters to B.Sc. (Ag.) students, providing a comprehensive resource to develop a deep understanding of the principles, significance, and practical applications of human values and ethics within the agricultural domain. This manual serves as a guide to help students cultivate a strong moral compass and make informed ethical decisions in their agricultural pursuits.

The manual covers a wide range of topics, tailored to the unique context of agricultural sciences. It explores the fundamental concepts of human values and ethics, ethical theories and frameworks relevant to agriculture, and the ethical dimensions of various agricultural practices and policies. Students will gain insights into the ethical considerations associated with sustainable agriculture, genetic engineering, pesticide use, animal welfare, land management, and social responsibility within rural communities.

Through engaging discussions, case studies, and interactive exercises, the manual encourages students to critically analyze ethical dilemmas specific to the agricultural sector. It promotes the development of ethical reasoning skills, encouraging students to consider the diverse stakeholders involved, including farmers, consumers, ecosystems, and future generations. Additionally, the manual emphasizes the importance of ethical leadership and responsible decision-making in agricultural settings.

The "Human Values and Ethics" e-reading manual emphasizes the practical application of ethical principles within the agricultural context. It equips students with tools to navigate complex ethical challenges, encouraging them to incorporate ethical considerations into their research, production practices, and interactions with stakeholders. The manual also highlights the role of agriculture in promoting social justice, environmental sustainability, and the well-being of rural communities.

With its specialized focus on agricultural ethics, this manual is a valuable resource for B.Sc. (Ag.) students, enabling them to integrate ethical principles into their academic and professional pursuits. By exploring the intersection of human values and agricultural practices, students will develop a strong ethical foundation, allowing them to contribute responsibly to the agricultural industry and address the ethical complexities it faces.

The "Human Values and Ethics" e-reading manual empowers B.Sc. (Ag.) students to become ethical leaders, capable of making informed decisions that balance economic viability, environmental stewardship, and societal well-being. By instilling a deep understanding of human values and ethics, this manual prepares students to navigate the moral challenges of agricultural sciences and contribute to the development of sustainable and ethically sound agricultural systems.

Director Research
B.U.A.T., Banda-210001 (U.P.)

Registrar
Banda University of Agriculture & Technology
Banda-210001 (U.P.)

Rural Agricultural Work Experience (RAWEX) Programme

B.Sc. (Hons.) Agriculture

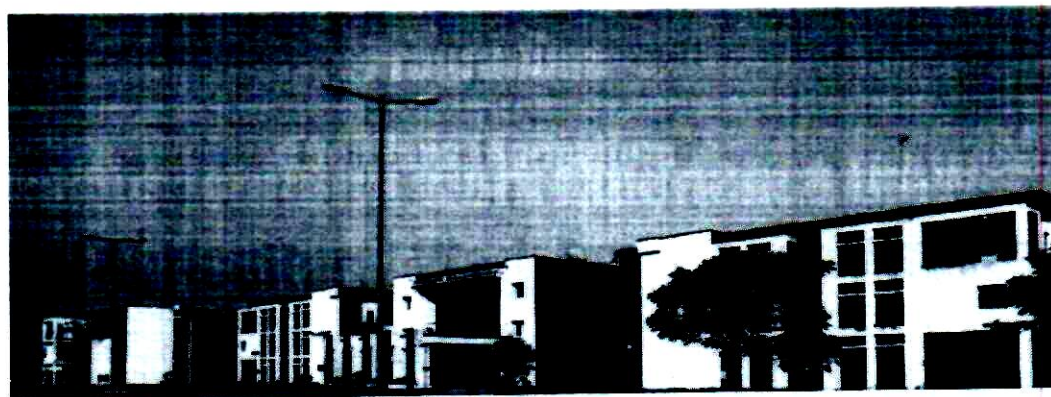

Prepared by

Pankaj Kumar Ojha

Bhoora Mishra

B.K. Gupta

Arjun Prasad Verma

B.P. Mishra

Department of Agricultural Extension

College of Agriculture

Banda University of Agriculture and Technology

Director Research
B.U.A.T., Banda-210001 (U.P.)

(S.K. Singh)
Registrar
Banda University of Agriculture & Technology
Banda-210001 (U.P.)

Manual for Rural Agricultural Work Experience (RHWE) Programme

Year

January, 2022

Copyright

Banda University of Agriculture and Technology, Banda

Publication No.: BUAT/(M)/2022/3

Prepared by:

Pankaj Kumar Ojha

Dheeraj Mishra

B.K. Gupta

Arjun Prasad Verma

B.P. Mishra

"The financial assistance received from Indian Council of Agricultural Research (ICAR), New Delhi towards publication of Manuals is gratefully acknowledged."

Published by:

College of Agriculture

Banda University of Agriculture and
Technology Banda-210001 (Uttar Pradesh)

Director Research
B.U.A.T., Banda-210001 (U.P.)

(S.K. Singh)
Registrar

Banda University of Agriculture & Technology
Banda-210001 (U.P.)

Abstract

The "Rural Agricultural Work Experience Programme" e-manual is specifically tailored to cater to the needs of B.Sc. (Ag.) final year students, providing them with a comprehensive guide to enhance their practical knowledge and skills in rural agricultural practices. This manual serves as a valuable resource to bridge the gap between theoretical learning and hands-on experience, preparing students for a successful transition into the agricultural industry.

The manual covers a wide range of topics essential to rural agricultural work experience. It delves into various aspects such as crop cultivation techniques, livestock management, farm machinery operation, agricultural entrepreneurship, and the integration of technology in rural farming practices. Additionally, the manual explores sustainable agricultural practices, resource management, and the socioeconomic factors that shape rural agricultural development.

Through detailed explanations, real-life case studies, and interactive exercises, the manual fosters active learning and critical thinking among B.Sc. (Ag.) final year students. It provides practical guidance on planning and executing agricultural projects, managing risks and challenges, and optimizing farm productivity. Students will also gain insights into the importance of ethical practices and sustainable approaches in rural agricultural work.

The "Rural Agricultural Work Experience Programme" e-manual serves as a valuable tool for B.Sc. (Ag.) final year students, empowering them to make the most of their work experience and excel in their future careers. By utilizing this manual, students will develop the necessary skills to effectively contribute to rural communities, promote sustainable farming practices, and drive agricultural development.

This comprehensive manual blends theoretical knowledge with practical application, enabling students to apply their learning in real-world scenarios. It equips them with the knowledge and confidence to navigate the challenges and intricacies of rural agricultural work, fostering their ability to make informed decisions, implement innovative practices, and adapt to the evolving demands of the agricultural sector.

The "Rural Agricultural Work Experience Programme" e-manual serves as a valuable asset for B.Sc. (Ag.) final year students, providing them with the necessary guidance and resources to excel in their work experience and establish successful careers in rural agriculture. By leveraging this manual, students will gain a holistic understanding of rural agricultural work and become skilled professionals capable of making a positive impact in the field.

Director Research
B.U.A.T., Banda-210001 (U.P.)

(S.K. Singh)
Registrar
Banda University of Agriculture & Technology
Banda-210001 (U.P.)

e-READING MANUAL

BS-3108

ENTREPRENEURSHIP DEVELOPMENT AND BUSINESS MANAGEMENT

2(1+1)

B.Sc. (Hons.) Forestry

**Prepared by
B.K. Gupta
Dheeraj Mishra
Pankaj Kumar Ojha
Arjun Prasad Verma
B.P. Mishra**

Department of Agricultural Extension

College of Agriculture

Banda University of Agriculture and Technology

Director Research
B.U.A.T., Banda-210001 (U.P.)

(S.K. Singh)
Registrar
Banda University of Agriculture & Technology
Banda-210001 (U.P.)

e-Reading Manual on

Entrepreneurship Development and Business Management

Year

January, 2022

Copyright

Banda University of Agriculture and Technology, Banda

Publication No.: BUAT/(M)/2022-15

Prepared by:

B.K. Gupta

Dheeraj Mishra

Pankaj Kumar Ojha

Arjun Prasad Verma

B.P. Mishra

Published by:

College of Agriculture

Banda University of Agriculture and Technology

Banda-210001 (Uttar Pradesh)

Director Research
B.U.A.T., Banda-210001 (U.P.)

(S.K. Singh)
Registrar
Banda University of Agriculture & Technology
Banda-210001 (U.P.)

ABSTRACT

Agricultural extension is a key to sustainable agricultural development. The global change in economic policies and advancement in technologies have brought a complete shift in extension approaches worldwide. It has introduced new trends such as market led extension, cyber extension and private extension to the discipline. In view of this, ICAR nominated the 5th Dean's Committee to suggest relevant modification and changes in the course curricula of all disciplines at UG level. The e-reading manual on BS-3108: Entrepreneurship Development and Business Management are designed as per the revised curricula of B.Sc. (Hons.) Forestry programme recommended by the 5th Dean's Committee of ICAR. The new chapters were added as per the revision and incorporated in such a way that made it easily understandable to the students to make it more clear and attractive. Pictures, graphs, figures, etc. are used at appropriate places.

This e-reading manual has been organized and having entire syllabus according to 5th Dean's Committee namely concept of entrepreneur, entrepreneurship types of entrepreneurs and functions, overall business environment, motivation, managing an enterprise, planning, budgeting, monitoring, evaluation and follow up in running an enterprise, entrepreneurship development programmes, Government schemes, policy and incentives for promotion of entrepreneurship. Overview of forestry inputs industry, export and import policies, characteristics of Indian forestry processing and export industry along with social responsibility of business were also cover in content.

Director Research
B.U.A.T., Banda-210001 (U.P.)

(S.K. Singh)
Registrar
Banda University of Agriculture & Technology
Banda-210001 (U.P.)

e-READING MANUAL

AEX-311 **ENTREPRENEURSHIP** **DEVELOPMENT AND BUSINESS** **COMMUNICATION**

2 (1+1)

B.Sc. (Hons.) Agriculture

Prepared by
B.K. Gupta
Dheeraj Mishra
Pankaj Kumar Ojha
Arjun Prasad Verma
B.P. Mishra

Department of Agricultural Extension
College of Agriculture
Banda University of Agriculture and Technology

Director Research
B.U.A.T., Banda-210001 (U.P.)

S.K. Singh
Registrar
Banda University of Agriculture & Technology
Banda-210001 (U.P.)

e-Reading Manual on Entrepreneurship Development and Business Communication

Year

January, 2022

Copyright

Banda University of Agriculture and Technology, Banda

Publication No.:

Prepared by:

B.K. Gupta

Dheeraj Mishra

Pankaj Kumar Ojha

Arjun Prasad Verma

B.P. Mishra

Published by:

College of Agriculture

Banda University of Agriculture and Technology

Banda-210001 (Uttar Pradesh)



Director Research
B.U.A.T., Banda-210001 (U.P.)



(S.K. Singh)

Registrar

Banda University of Agriculture & Technology
Banda-210001 (U.P.)

ABSTRACT

An entrepreneur plays an important role in accelerating the pace of economic development of a country, by discovering new uses of available resources and maximizing their utilization. Today, when India is a fast developing economy, the contribution of entrepreneurs has increased multi-fold. The major functions of entrepreneurs are innovation and creativity, risk taking and achievement and organization and management, catalyst of economic development, overcoming resistance to change and research. Entrepreneurship is the dynamic process of creating gradual wealth. This wealth is created by individuals who assume the major risks in terms of wealth, equity, time, and/or career commitment of providing value/identity for some product or service in the market. In very short it can be said that entrepreneurship is kind of activities done by the individual as an entrepreneur.

The e-course manual on "Entrepreneurship Development and Business Communication" is prepared according to the syllabus recommended by the fifth dean committee report and offered in Under Graduate Programme of Department of Agricultural Extension, CoA, BUAT, Banda. This study material is prepared with the help of various textbook, online sources such as University websites, e-documents, e- books, e-data and other offline sources. This course covers Government policy and programmes and institutions for entrepreneurship development

SWOT Analysis, motivation & achievement motivation, motivating factors for entrepreneurship development. Agribusiness in Indian Economy ,impact and importance of economic reforms on Agribusiness/ Agrienterprises business, leadership skills developing organizational skills management of an enterprise, problem solving skill, supply chain management and total quality management, developing managerial skills, business leadership skills which are very effective as per the requirements of the students.

Director Research
B.U.A.T., Banda-210001 (U.P.)

(S.K. Singh)
Registrar
Banda University of Agriculture & Technology
Banda-210001 (U.P.)

E-Practical Cum Teaching Manual

FP2202, 3(2+1)
Wood Products Utilization
B.Sc. (Hons.) Forestry

Prepared by

Dr. Yogesh Y. Sumthane

Dr. Kulwant Rai Sharma

Dr. Sanjeev Kumar

DEPARTMENT OF FOREST PRODUCTS

COLLEGE OF FORESTRY

BANDA UNIVERSITY OF AGRICULTURE AND TECHNOLOGY, BANDA
210001 (UTTAR PRADESH) INDIA

Director Research
B.U.A.T., Banda-210001 (U.P.)

(S.K. Singh)
Registrar
Banda University of Agriculture & Technology
Banda-210001 (U.P.)

E-Practical cum Teaching Manual

Wood Products Utilization

Year

April, 2023

Copyright:

Banda University of Agriculture and Technology, Banda

Publication No: BUAT/ (M)/2023/22

Prepared by

Dr. Yogesh Y. Sumthane

Dr. Kulwant Rai Sharma

Dr. Sanjeev Kumar

Published by:

College of Forestry

Banda University of Agriculture and Technology

Banda-210001 (Uttar Pradesh)

Director Research
B.U.A.T., Banda-210001 (U.P.)

2 
(S.K. Singh)
Registrar
Banda University of Agriculture & Technology
Banda-210001 (U.P.)

E-PRACTICAL CUM TEACHING MANUAL

FP3105

Logging and Ergonomics

2(1+1)

B.Sc. (Hons.) Forestry

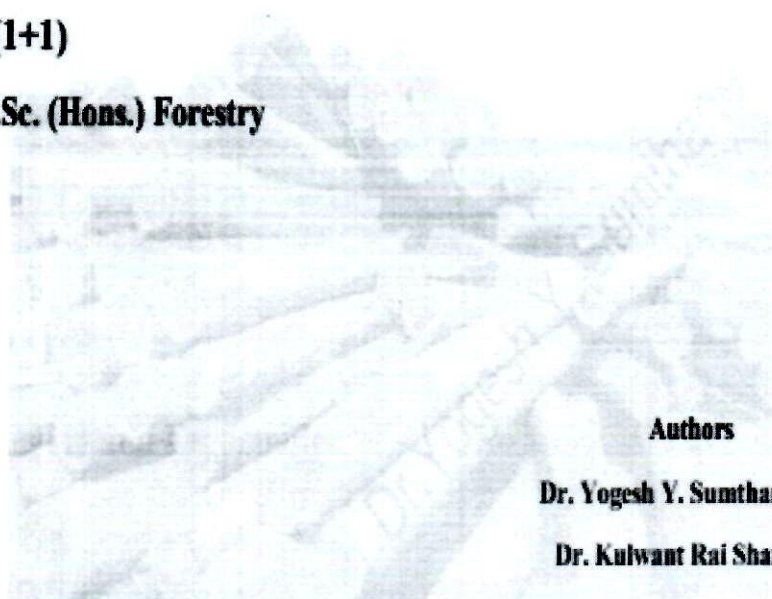

Authors

Dr. Yogesh Y. Sumthane

Dr. Kulwant Rai Sharma

Dr. Sanjeev Kumar

DEPARTMENT OF FOREST PRODUCTS

COLLEGE OF FORESTRY

**BANDA UNIVERSITY OF AGRICULTURE AND
TECHNOLOGY, BANDA 210001 (UTTAR PRADESH) INDIA**

Director Research
B.U.A.T., Banda-210001 (U.P.)

(S.K. Singh)
Registrar
Banda University of Agriculture & Technology
Banda-210001 (U.P.)

E-Practical cum Teaching Manual

Logging and Ergonomics

Year

April, 2023

Copyright:

Banda University of Agriculture and Technology, Banda

Publication NO: BUAT/ (M)/2023/23

Prepared by

Dr. Yogesh Y. Sumthane

Dr. Kulwant Rai Sharma

Dr. Sanjeev Kumar

Published by:

College of Forestry

Banda University of Agriculture and Technology

Banda-210001 (Uttar Pradesh) INDIA.

The Relevance and an Importance of E-Learning Manuals in Higher Education

Yogesh Y. Sumthane, Kulwant Rai Sharma, Sanjeev Kumar

Banda University of Agriculture and Technology, Banda Uttar Pradesh India.

Dr.Y.S. Parmar University of Horticulture and Forestry Nauni, Solan Himachal Pradesh

ABSTRACT: E-learning is a technology which supports teaching and learning via a computer and the web technology. It bridges the gap between a teacher and a student in two different geographical locations. Advancement in internet and multimedia technology is the basic enable for e-learning. E-learning applications facilitate online access to learning content and administration. Despite much enthusiasm about the roles of technology in education, its role in transforming teacher learning, in ways aligned with advances in the learning sciences and contemporary socio-cultural perspectives, few changes have occurred. While many teacher educators are turning away from technology, after early attempts met with mitigated success, some are pushing the boundaries of teacher education and professional activity systems. This study identifies and analyzes emerging trends and models in e-learning for teacher education and professional development from the developing research base, both international trends and current developments. Educational institutions and teaching staff have many benefits due to emergence of modern technology. Teachers have their own networks through which they connect themselves with other teachers across the globe. Institutions have web-supported classrooms. Similarly, it also enhanced the responsibilities of schools, colleges, and universities that should have such teachers who can produce such students, who after receiving their education can adjust themselves at any platform.

KEY WORD: E-learning, higher education, multimedia technology, teaching and learning, networks, online access, and professional development.

Director Research
B.U.A.T., Banda-210001 (U.P.)

S.K. Singh
Registrar
Banda University of Agriculture & Technology
Banda-210001 (U.P.)